

! Please note

- ▶ **Injections take place just once a week.** On a specific day.
- ▶ Only use the pen before the expiration date and if the solution is yellow and clear.
- ▶ Potential air bubbles in the solution are not harmful and are not removed before injection.
- ▶ These instructions do not supersede the patient information leaflet. Please read it carefully.

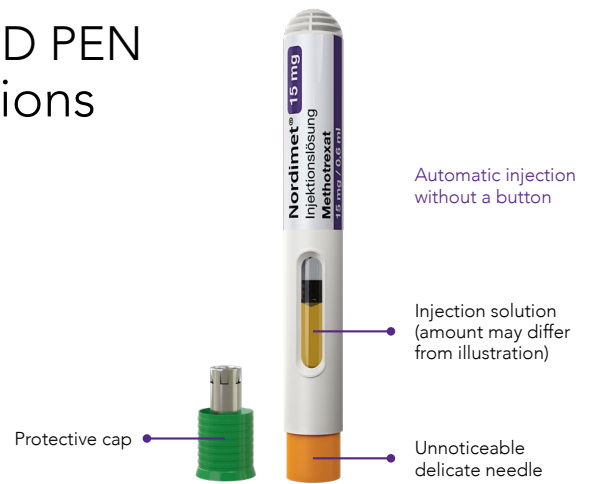

Preparing the injection



- ▶ Clean your hands thoroughly.
- ▶ Lay out the pre-filled pen and alcohol pads ready.
- ▶ Select an injection site (lower stomach, a few centimetres away from the belly button, or on the front of the thigh).
- ▶ Clean the injection site with the alcohol pads included.
- ▶ Please remember to change the injection site for each injection.

Performing the injection



- ▶ Remove the protective cap and hold the pre-filled pen in your hand.
- ▶ The orange-coloured needle guard should not touch anything before the injection.



- ▶ Form a skin fold at the cleaned injection site with your thumb and index finger.
- ▶ Place the pre-filled pen with the orange needle guard fully onto the skin fold at a 90-degree angle.
- ▶ Push the pen down into the skin fold. The injection begins automatically with an audible "click".

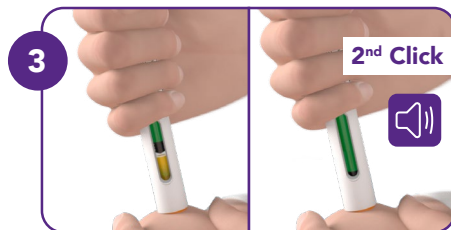

- ▶ Keep pushing the pen into the skin fold until you hear a second "click". The injection is now complete.
- ▶ Wait for 3 seconds afterwards.

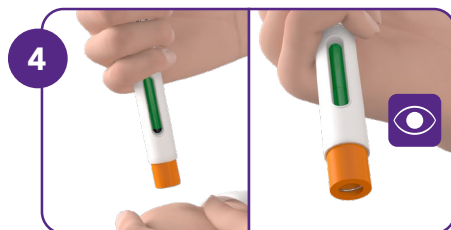

- ▶ Lift away the pen and release the skin fold.
- ▶ The green indicator in the viewing window shows that the injection is complete.
- ▶ The needle is automatically locked in the pen.



A video on the use of the NORDiMET® pre-filled pen can be found at www.nordimet.de